

**2-Step  
Fixed Height Stairway**

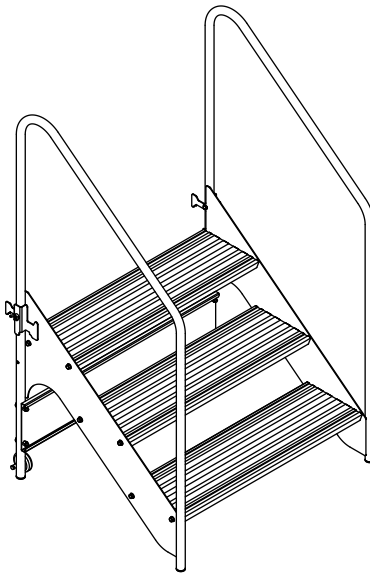

**3-Step  
Fixed Height Stairway**

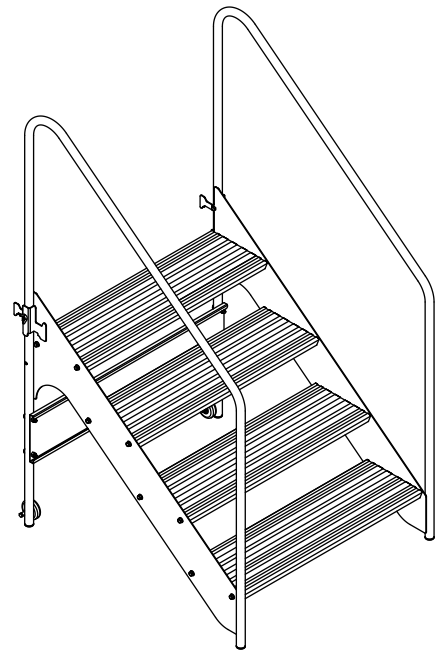

**4-Step  
Fixed Height Stairway**

### Contents

Important User Information .....	2	Required Tools .....	3
General .....	2	Supplied Hardware .....	3
Manufacturer .....	2	Parts List .....	4
Intended Use .....	2	Assembly .....	5
Warranty .....	2	Installation .....	8
Safety Precautions .....	3		



Visit the Fixed Height Stairway web page at [wengercorp.com](http://wengercorp.com) for more information.

**Note:** Please read and understand these instructions before proceeding.

**Note:** If you need additional information, contact Wenger Corporation using the information below.

# ***Important User Information***

---

## ***General***

Copyright © 2024 by Wenger Corporation

All rights reserved. No part of the contents of this manual may be reproduced, copied, or transmitted in any form or by any means including graphic, electronic, or mechanical methods or photocopying, recording, or information storage and retrieval systems without the written permission of the publisher, unless it is for the purchaser's personal use.

Printed and bound in the United States of America.

The information in this manual is subject to change without notice and does not represent a commitment on the part of Wenger Corporation. Wenger Corporation does not assume any responsibility for any errors that may appear in these instructions.

In no event will Wenger Corporation be liable for technical or editorial omissions made herein, nor for direct, indirect, special, incidental, or consequential damages resulting from the use or defect of these instructions. The manufacturer reserves the right to change this product at any time.

The information in this document is not intended to cover all possible conditions and situations that might occur. The end user must exercise caution and common sense when assembling or installing Wenger Corporation products. If any questions or problems arise, call the Wenger Corporation at (800) 4WENGER (493-6437) or +1-507-455-4100 worldwide.

## ***Manufacturer***

The Fixed Height Stairway is manufactured by:

Wenger Corporation  
555 Park Drive  
Owatonna, MN 55060  
(800) 4WENGER (493-6437) • +1 (507) 455-4100  
wengercorp.com

## ***Intended Use***

- This product is intended for indoor use in normal ambient temperature and humidity conditions – it must not be exposed to prolonged outside weather conditions.
- This product is intended to be assembled and used only as described in these instructions.

## ***Warranty***

Warranty information is available at [wengercorp.com](http://wengercorp.com).

## Safety Precautions

---

Throughout this document you may find cautions and warnings which are defined as follows:

- **WARNING:** Failure to follow the instruction could result in serious injury or damage to property.
- **CAUTION:** Failure to follow the instruction could result in minor injury or damage to property.

Read all of these safety instructions before using the equipment.

### **CAUTION**

*Make sure anyone assembling, installing or using this product has read and understands these instructions.*

### **CAUTION**

*Failure to comply with Warnings and Cautions in this document or on the equipment can result in damage to property or injury.*

## Required Tools

---

- 9/16" Socket or open end/box end wrench
- 5/32" Allen wrench (included in hardware pack)

## Supplied Hardware

---

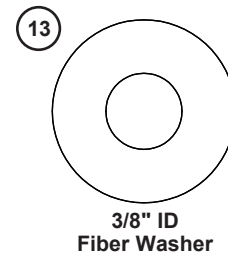
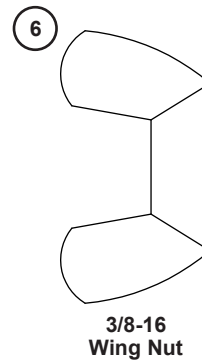
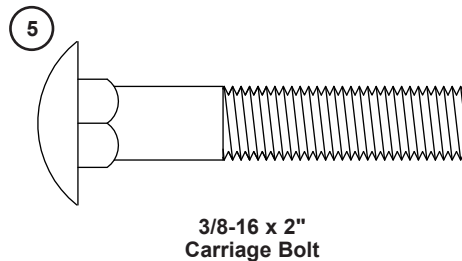
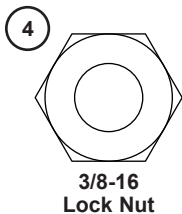
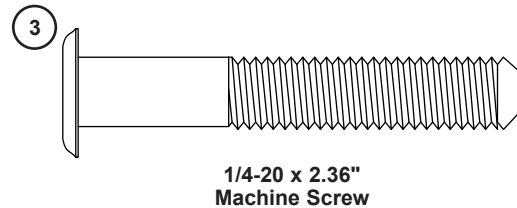
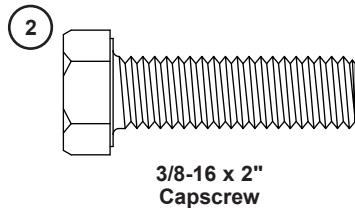
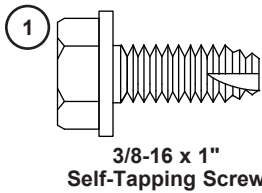

# Parts List

## 2-Step Model

Item	Qty	Description
1	8	3/8-16 x 1" Self-Tapping Screw
2	2	3/8-16 x 2" Capscrew
3	2	1/4-20 x 2.36" Base Machine Screw (2-Step Model)
4	0	3/8-16 Lock Nut (3-Step, 4-Step Models)
5	0	3/8-16 x 2" Carriage Bolt (3-Step, 4-Step Models)
6	2	3/8-16 Wing Nut
7	2	Step Assembly
8	1	Hand Rail Assembly, Left-Hand
9	1	Hand Rail Assembly, Right-Hand
10	1	Cross Brace (2-Step Model)
11	0	Cross Base (3-Step, 4-Step Models)
12	2	Connection Bracket
13	3	3/8" ID Fiber Washer

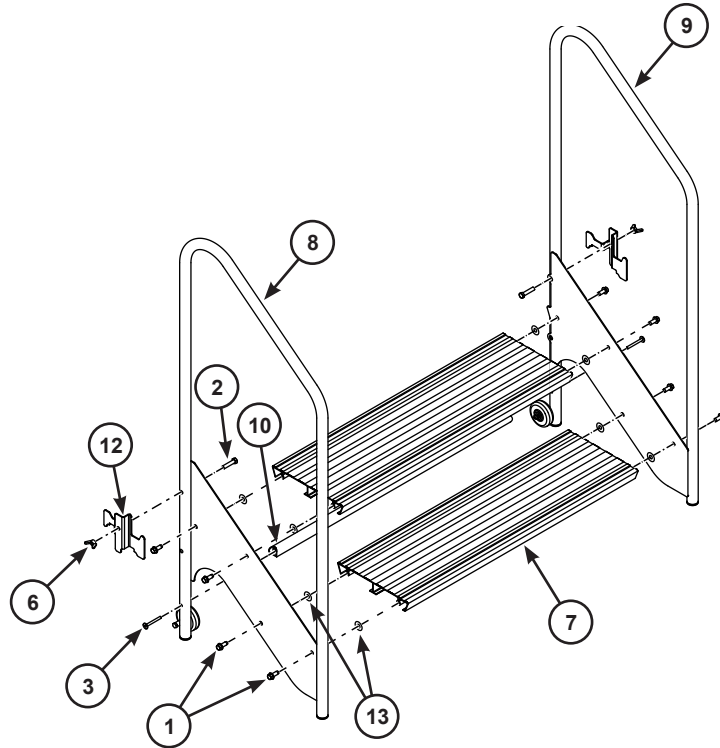

## 3-Step and 4-Step Models

Item	3-Step Qty	4-Step Qty	Description
1	12	16	3/8-16 x 1" Self-Tapping Screw
2	2	2	3/8-16 x 2" Capscrew
3	0	0	1/4-20 x 2.36" Base Machine Screw (2-Step Model)
4	4	4	3/8-16 Lock Nut (3-Step, 4-Step Models)
5	4	4	3/8-16 x 2" Carriage Bolt (3-Step, 4-Step Models)
6	2	2	3/8-16 Wing Nut
7	3	4	Step Assembly
8	1	1	Hand Rail Assembly, Left-Hand
9	1	1	Hand Rail Assembly, Right-Hand
10	0	0	Cross Brace (2-Step Model)
11	1	1	Cross Base (3-Step, 4-Step Models)
12	2	2	Connection Bracket
13	12	16	3/8" ID Fiber Washer

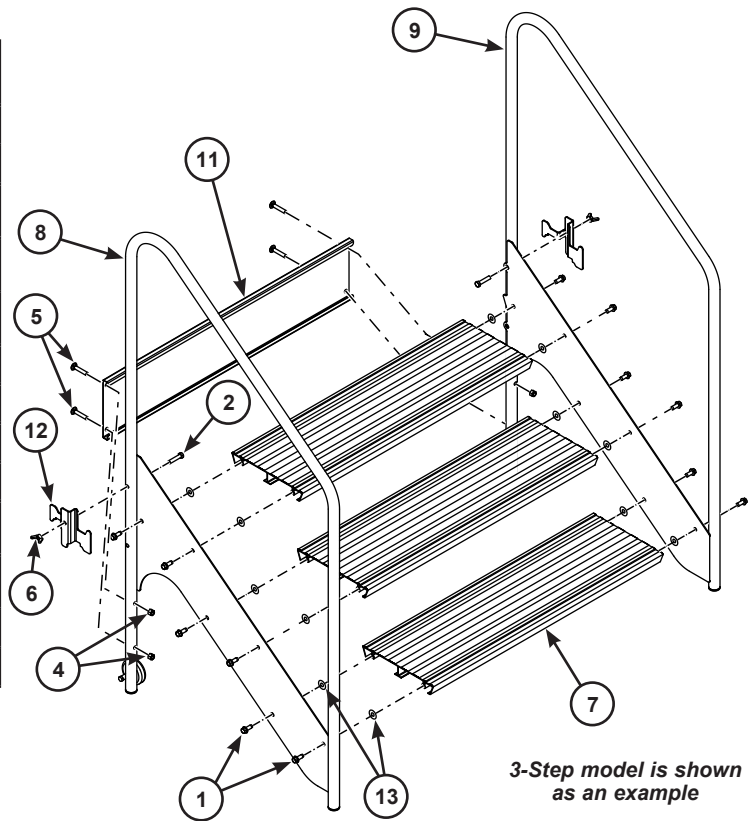

3-Step model is shown as an example

# Assembly

1. Attach the step assemblies (7) to the left-hand (8) and right-hand (9) hand rail assemblies using two 3/8-16 x 1" self-tapping screws (1) and two 3/8" ID fiber washers (13) on each side.  
**The wheel on both of the hand rail assemblies must face toward the inside as shown.**

The fiber washers will help reduce rubbing between the step assemblies and hand rail assemblies.

Screw the self-tapping screws through the pilot holes in the hand rail assembly and into the channels on the underside of the step assembly.

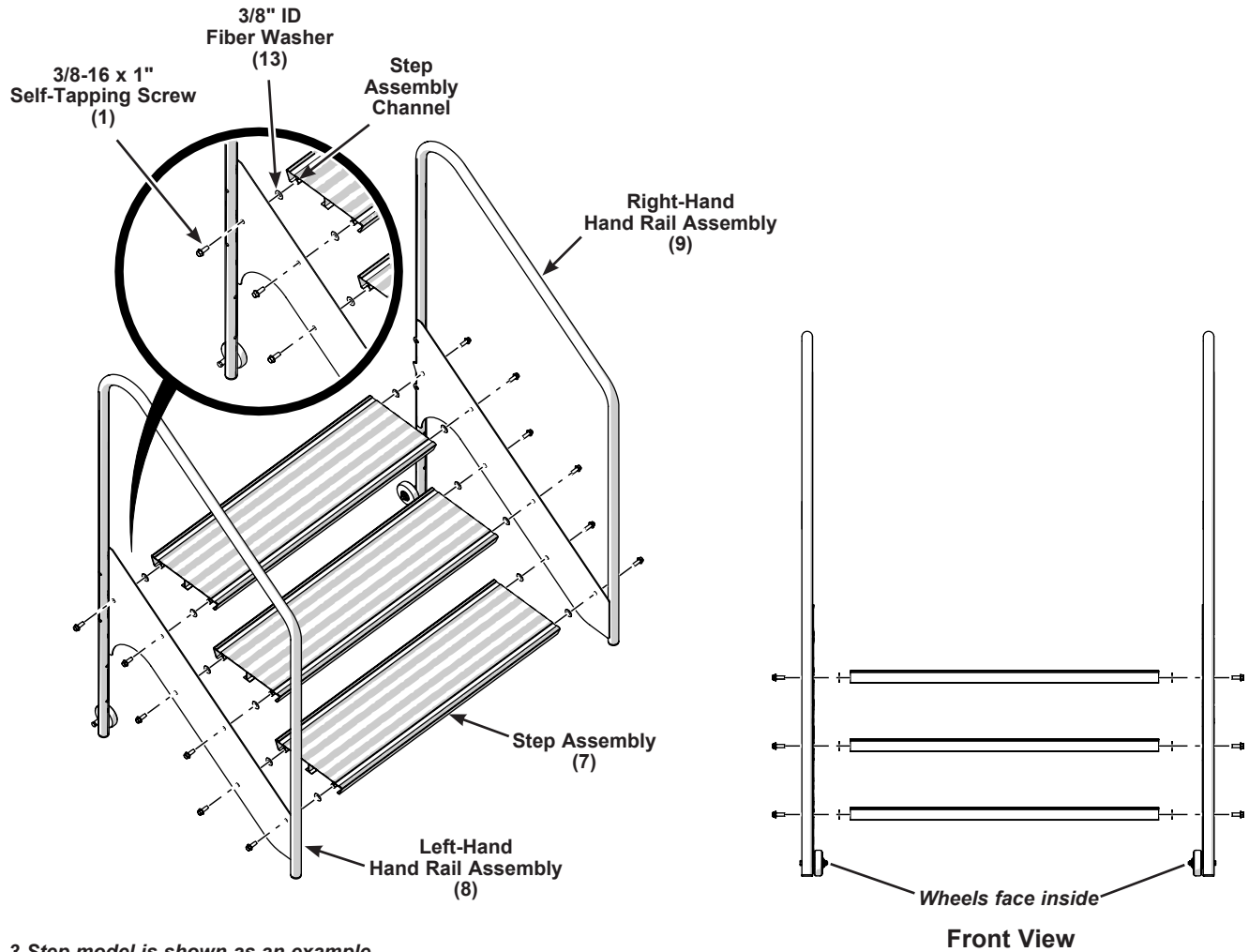

3-Step model is shown as an example

## Assembly (continued)

- Attach the cross brace (10) or cross base (11) depending on model to the hand rail assemblies.

### 2-Step Model

Attach the cross brace (10) to the left-hand (8) and right-hand (9) hand rail assemblies using one 1/4-20 x 2.36" machine screw in each side as shown.

Align each end of the cross brace with the **bottom** pilot hole in each hand rail assembly and secure using a machine screw on each end.

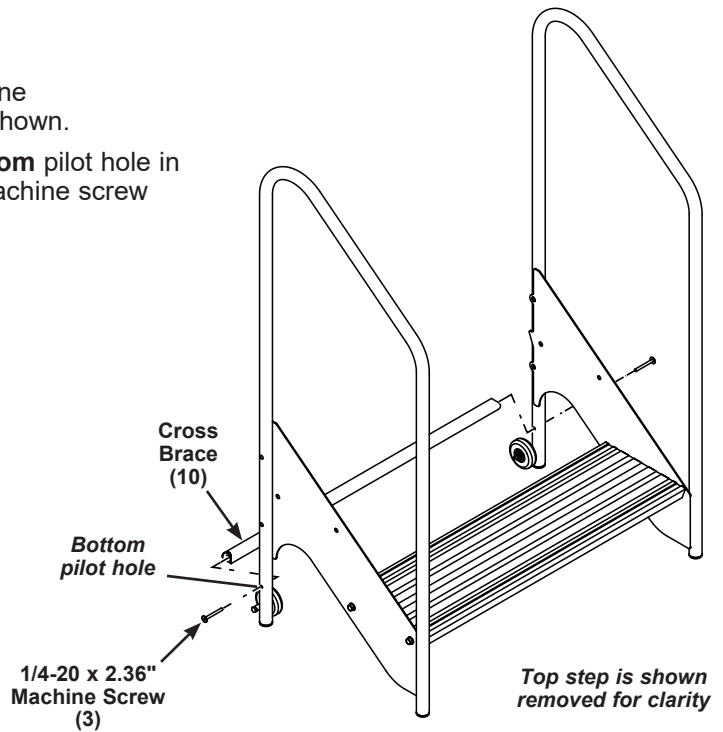

### 3-Step and 4-Step Models

Attach the cross base (11) to the left-hand (8) and right-hand (9) hand rail assemblies using two 3/8-16 x 2" carriage bolts (5) and two 3/8-16 lock nuts (4) in each side as shown.

Align each end of the cross base with the two pilot holes in each hand rail assembly and secure using the carriage bolts and lock nuts.

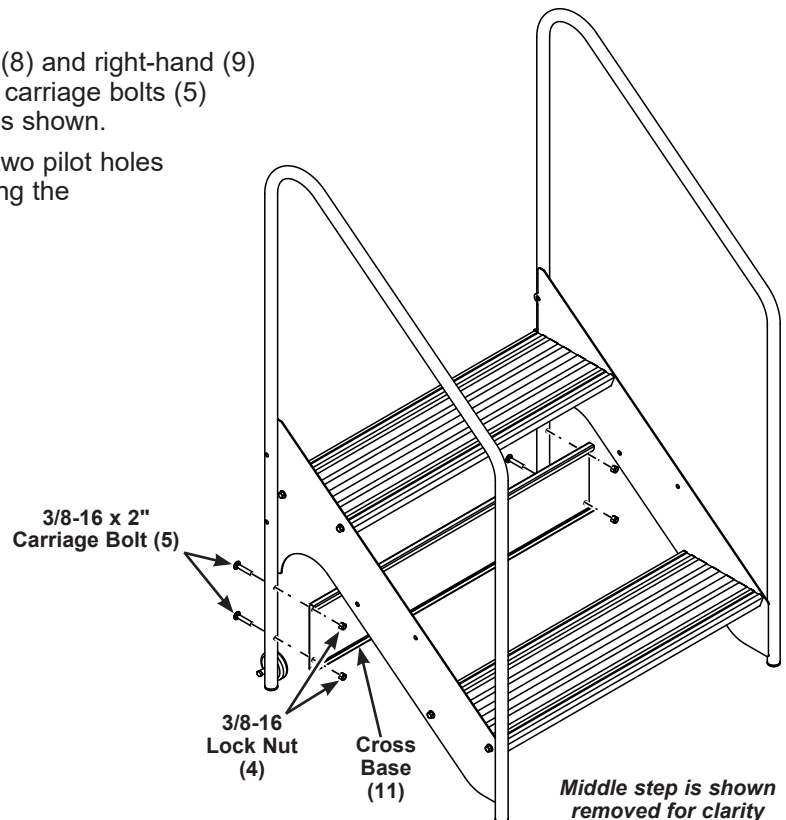

# Assembly (continued)

- Attach one connection bracket (12) to both the left-hand rail assembly (8) and the right-hand rail assembly (9) using one 3/8-16 x 2" capscrew (2) and one 3/8-16 wing nut (6) in each as shown.

Orient the connection bracket according to the type of stage being used as referenced below.

Depending on the stairway model and stage deck elevation, align the pilot hole in each connection bracket with either the top or bottom pilot hole in each hand rail assembly according to the chart below and secure using the capscrew and wing nut.

Stairway Model	Stage Deck Elevation	Connection Bracket Location
2-Step	16" (406 mm)	Bottom Hole
	24" (610 mm)	Top Hole
3-Step	24" (610 mm)	Bottom Hole
	32" (813 mm)	Top Hole
4-Step	32" (813 mm)	Bottom Hole
	40" (1016 mm)	Top Hole

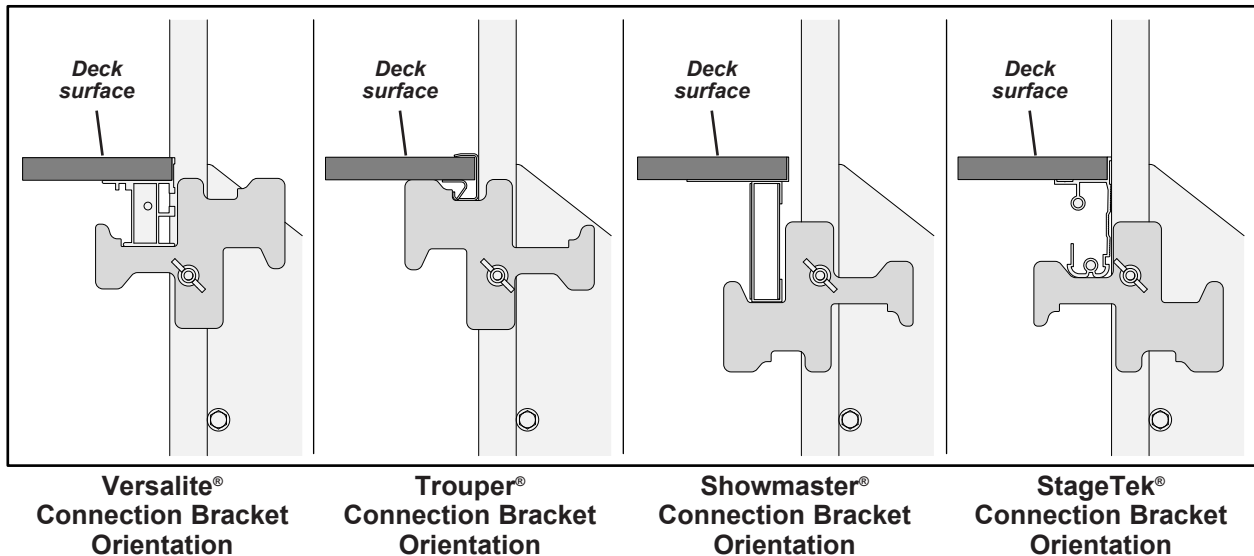
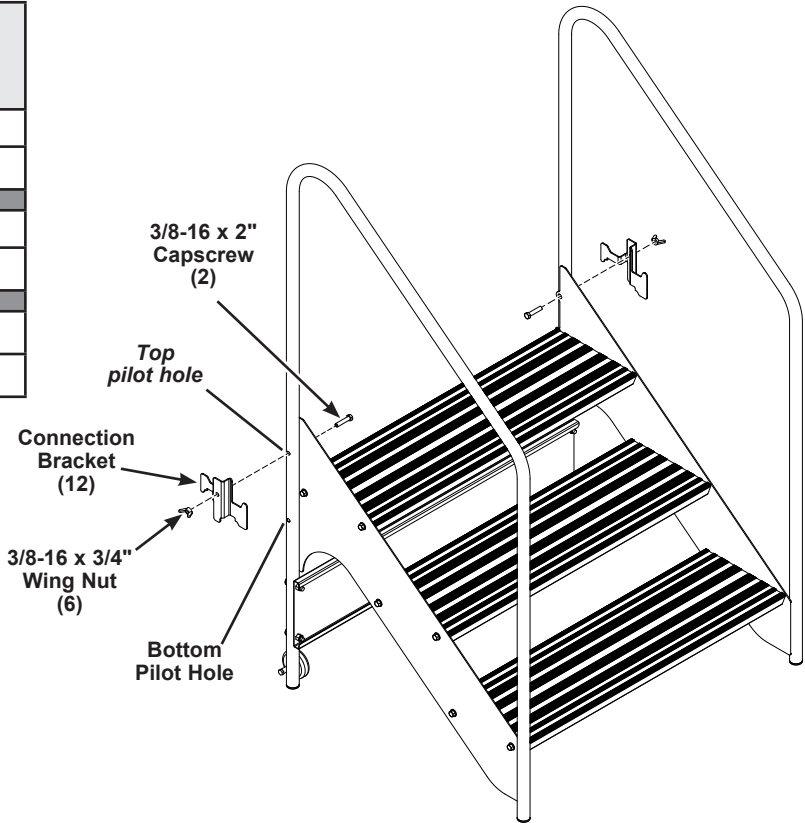

## ***Installation***

---

1. Slightly tilt the fixed height stairway forward and slide it under the stage so the connection brackets will engage with the edge of the stage deck as shown on the previous page.
2. Tilt the fixed height stairway back to the ground to grip the stage deck.

### **⚠ CAUTION**

*Be sure all adjustment knobs and fasteners are tight before using the stairway.*

